



SPORTSFIELD SPECIALTIES

www.sportsfield.com | 888-975-3343

*Excellence from
Design to Installation*



Outfield Batter's Eye



Sportsfield Specialties, Inc. 41155 State Hwy 10. Delhi, NY 13753



Outfield Batter's Eye

Product Overview

- Ideal backdrop for baseball and softball hitters at all levels
- Solid surface metal wall paneling and solid vinyl models available!
- Solid vinyl models are opaque with low-gloss matte finish and are stronger than industry standard mesh winscreen
- Professionally pre-engineered systems available in multiple sizes
- Variety of standard colors available for both structure and mesh
- Choose from direct embedment or base plate mounted install
- Custom sizes and/or designs available upon request
- Digital graphics available upon request with select models



Pre-Engineered Solutions for All Levels of Play

Item Number	Product Description
BE2040	20'H x 40'L Batter's Eye - solid vinyl enclosure, direct embedment
BE2040PL	20'H x 40'L Batter's Eye - solid vinyl enclosure, plate mounted
BESR2040	20'H x 40'L Batter's Eye - solid surface ribbed panels, direct embedment
BESR2040PL	20'H x 40'L Batter's Eye - solid surface ribbed panels, plate mounted
BESF2040	20'H x 40'L Batter's Eye - solid surface flush panels, direct embedment
BESF2040PL	20'H x 40'L Batter's Eye - solid surface flush panels, plate mounted
BE3060	30'H x 60'L Batter's Eye - solid vinyl enclosure, direct embedment
BE3060PL	30'H x 60'L Batter's Eye - solid vinyl enclosure, plate mounted
BESR3060	30'H x 60'L Batter's Eye - solid surface ribbed panels, direct embedment
BESR3060PL	30'H x 60'L Batter's Eye - solid surface ribbed panels, plate mounted
BESF3060	30'H x 60'L Batter's Eye - solid surface flush panels, direct embedment
BESF3060PL	30'H x 60'L Batter's Eye - solid surface flush panels, plate mounted
BE4080	40'H x 80'L Batter's Eye - solid vinyl enclosure, direct embedment
BE4080PL	40'H x 80'L Batter's Eye - solid vinyl enclosure, plate mounted
BESR4080	40'H x 80'L Batter's Eye - solid surface ribbed panels, direct embedment
BESR4080PL	40'H x 80'L Batter's Eye - solid surface ribbed panels, plate mounted
BESF4080	40'H x 80'L Batter's Eye - solid surface flush panels, direct embedment
BESF4080PL	40'H x 80'L Batter's Eye - solid surface flush panels, plate mounted
PESBE	Stamped drawings and calculations by a licensed professional engineer, direct embedment
PESBEPL	Stamped drawings and calculations by a licensed professional engineer, plate mounted

Standard Black Powder Coated Finish on Framing Components, Various Standard Colors Available

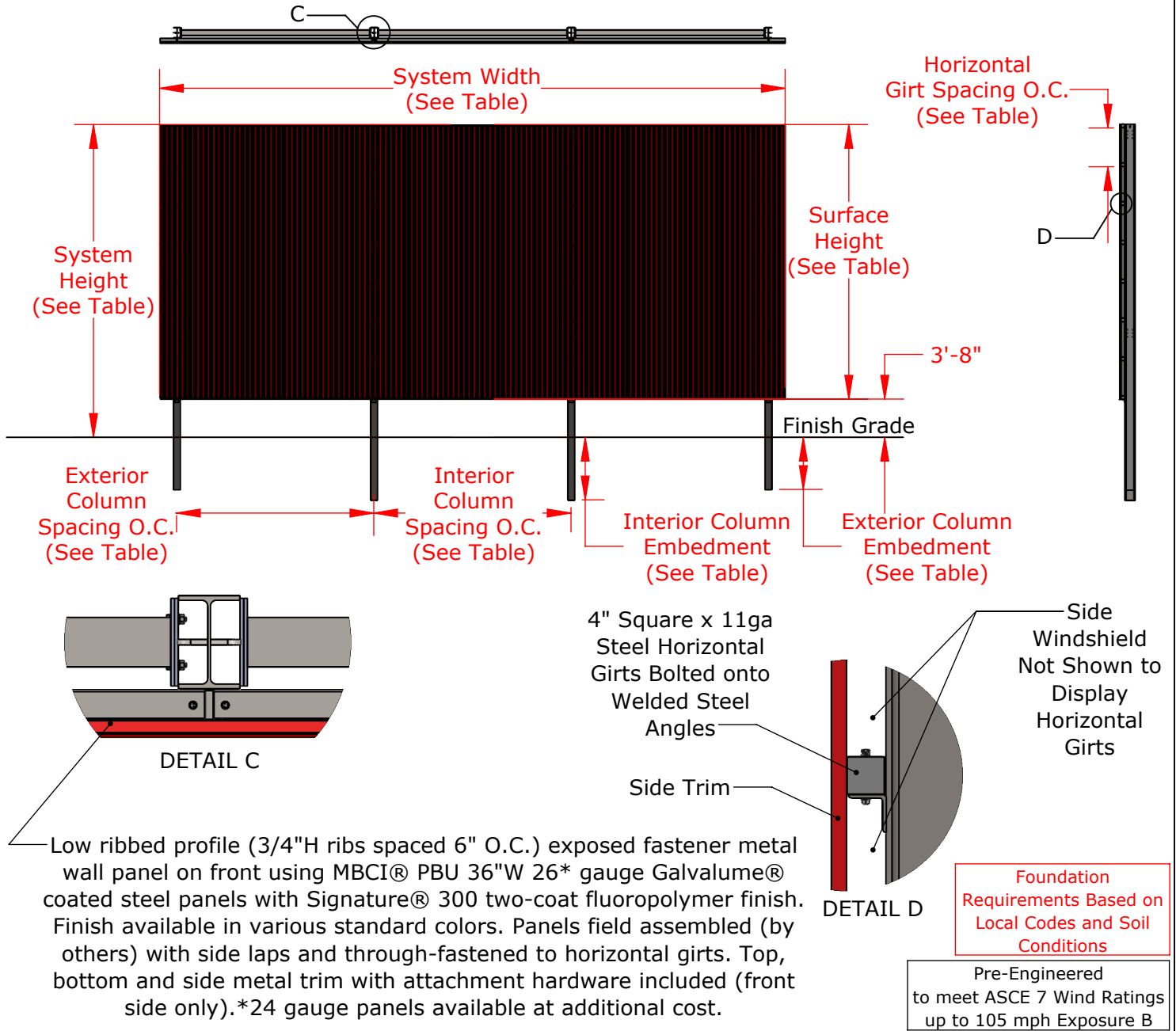

Part No.	System Height	System Width	Surface Height	# of Columns	Interior Column Spacing (O.C.)	Exterior Column Spacing (O.C.)	Interior Column Embedment	Exterior Column Embedment	Horizontal Girt Spacing (O.C.)
BESR2040S	20'-0"	40'-0"	16'-4"	3	18'-9 1/2"	18'-9 1/2"	4'-0"	4'-0"	5'-4"
BESR3060S	30'-0"	60'-0"	26'-4"	4	18'-11"	18'-11"	6'-0"	5'-0"	3'-8 5/8"
BESR3660S	36'-0"	60'-0"	32'-4"	4	19'-1"	19'-1"	8'-0"	6'-0"	4'
BESR4080S	40'-0"	80'-0"	36'-4"	5	19'-1 5/16"	19'-1 1/4"	8'-0"	8'-0"	4'

PROPRIETARY AND CONFIDENTIAL

THE INFORMATION CONTAINED IN THIS DRAWING IS THE SOLE PROPERTY OF SPORTSFIELD SPECIALTIES INC. ANY REPRODUCTION IN PART OR AS A WHOLE WITHOUT THE WRITTEN PERMISSION OF SPORTSFIELD SPECIALTIES INC. IS PROHIBITED.

**Solid Surface Batter's Eye with Ribbed Profile Wall
Panels and Exposed Fasteners, Direct Embedment, Single Sided**

Not To Scale

Sportsfield Specialties Inc 11142023

Part No.	Exterior Column Size	Interior Column Size	Beam Size
BESR2040S	W8x24	W8X24	W8X13
BESR3060S	W12X45	W12X50	W12X26
BESR3660S	W14X61	W14X68	W12X26
BESR4080S	W16X67	W16X77	W12X26

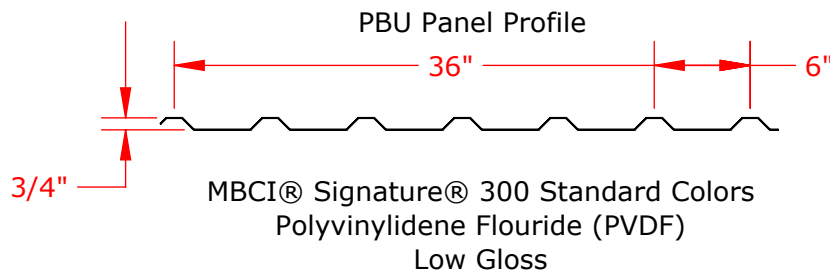
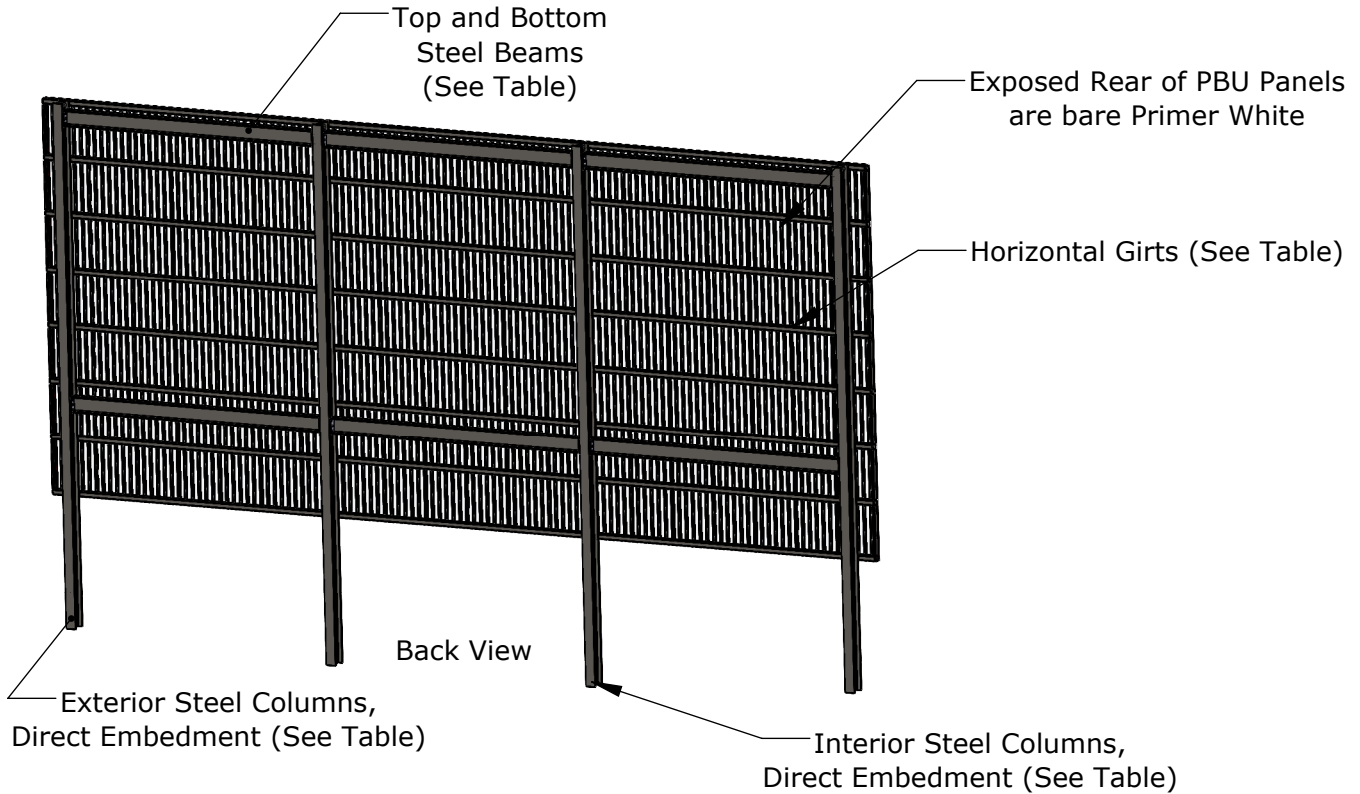

Harbor Blue



Colonial Red



Midnight Bronze



Classic Green



Hunter Green

Color output may not be exact as on this document due to variations in monitors and printers. Color approval must be based on specific color samples rather than their visual representation in this document.

PROPRIETARY AND CONFIDENTIAL

THE INFORMATION CONTAINED IN THIS DRAWING IS THE SOLE PROPERTY OF SPORTSFIELD SPECIALTIES INC. ANY REPRODUCTION IN PART OR AS A WHOLE WITHOUT THE WRITTEN PERMISSION OF SPORTSFIELD SPECIALTIES INC. IS PROHIBITED.

**Solid Surface Batter's Eye with Ribbed Profile Wall
Panels and Exposed Fasteners, Direct Embedment, Single Sided**

Not To Scale

Sportsfield Specialties Inc 11142023

Standard Black Powder Coated Finish on Framing Components, Various Standard Colors Available

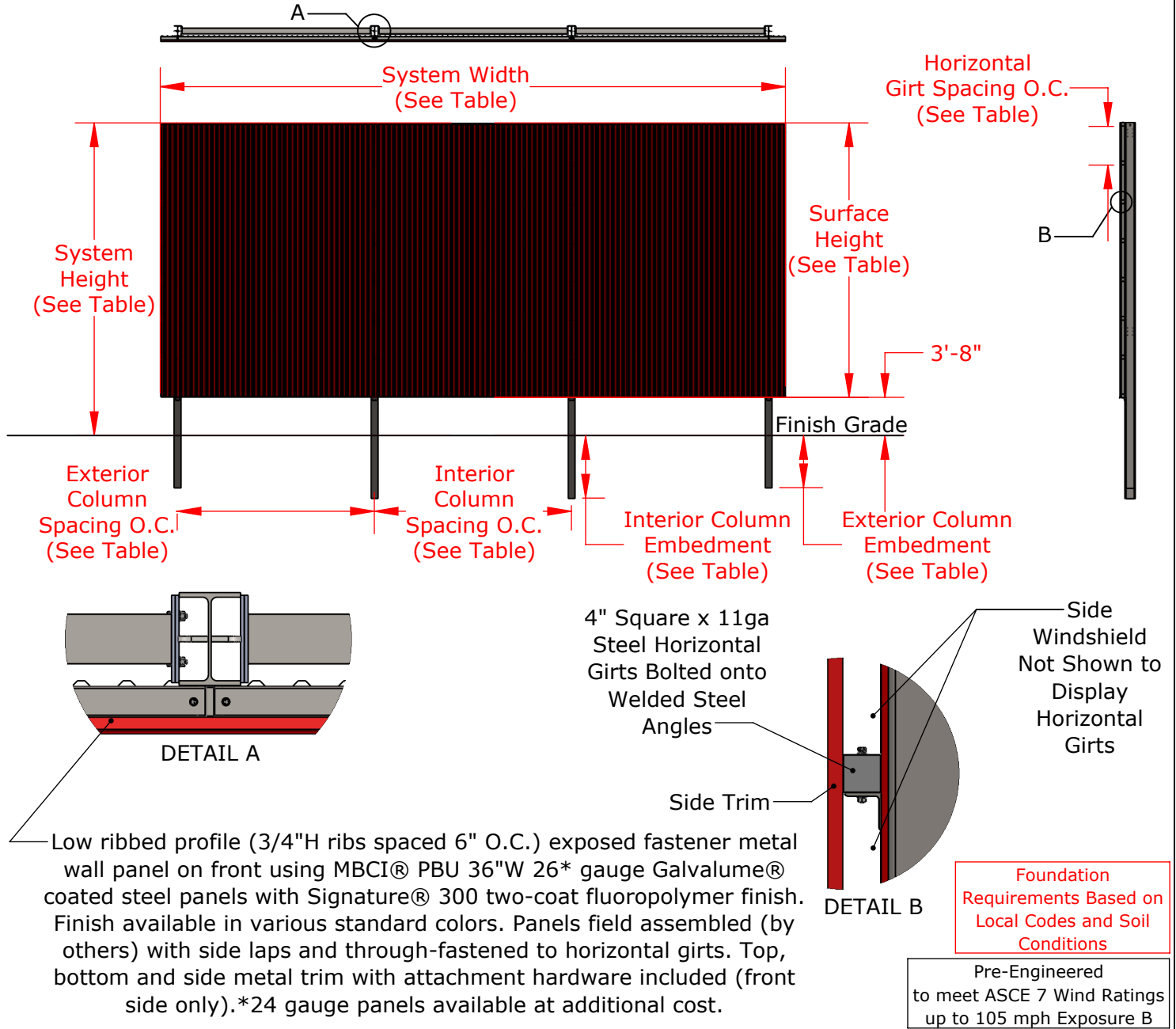

Part No.	System Height	System Width	Surface Height	# of Columns	Interior Column Spacing (O.C.)	Exterior Column Spacing (O.C.)	Interior Column Embedment	Exterior Column Embedment	Horizontal Girt Spacing (O.C.)
BESR2040	20'-0"	40'-0"	16'-4"	3	18'-9 1/2"	18'-9 1/2"	4'-0"	4'-0"	5'-4"
BESR3060	30'-0"	60'-0"	26'-4"	4	18'-11"	18'-11"	6'-0"	5'-0"	3'-8 5/8"
BESR3660	36'-0"	60'-0"	32'-4"	4	19'-1"	19'-1"	8'-0"	6'-0"	4'
BESR4080	40'-0"	80'-0"	36'-4"	5	19'-1 5/16"	19'-1 1/4"	8'-0"	8'-0"	4'

PROPRIETARY AND CONFIDENTIAL

THE INFORMATION CONTAINED IN THIS DRAWING IS THE SOLE PROPERTY OF SPORTSFIELD SPECIALTIES INC. ANY REPRODUCTION IN PART OR AS A WHOLE WITHOUT THE WRITTEN PERMISSION OF SPORTSFIELD SPECIALTIES INC. IS PROHIBITED.

Solid Surface Batter's Eye with Ribbed Profile Wall Panels and Exposed Fasteners, Direct Embedment, Double Sided

Not To Scale

Sportsfield Specialties Inc 11142023

Part No.	Exterior Column Size	Interior Column Size	Beam Size
BESR2040	W8x24	W8x24	W8x13
BESR3060	W12x45	W12x50	W12x26
BESR3660	W14x61	W14x68	W12x26
BESR4080	W16x67	W16x77	W12x26

Low ribbed profile (3/4" H ribs spaced 6" O.C.) exposed fastener metal wall panels on back located between columns using MBCI® PBU 36"W 26* gauge Galvalume® coated steel panels. Signature® 300 two-coat fluoropolymer finish. Finish available in various standard colors. Panels field assembled (by others) with side laps and through fastened to horizontal girts. *24 gauge panels available at additional cost.

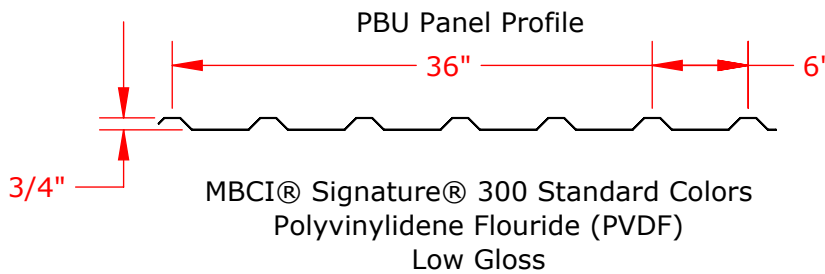
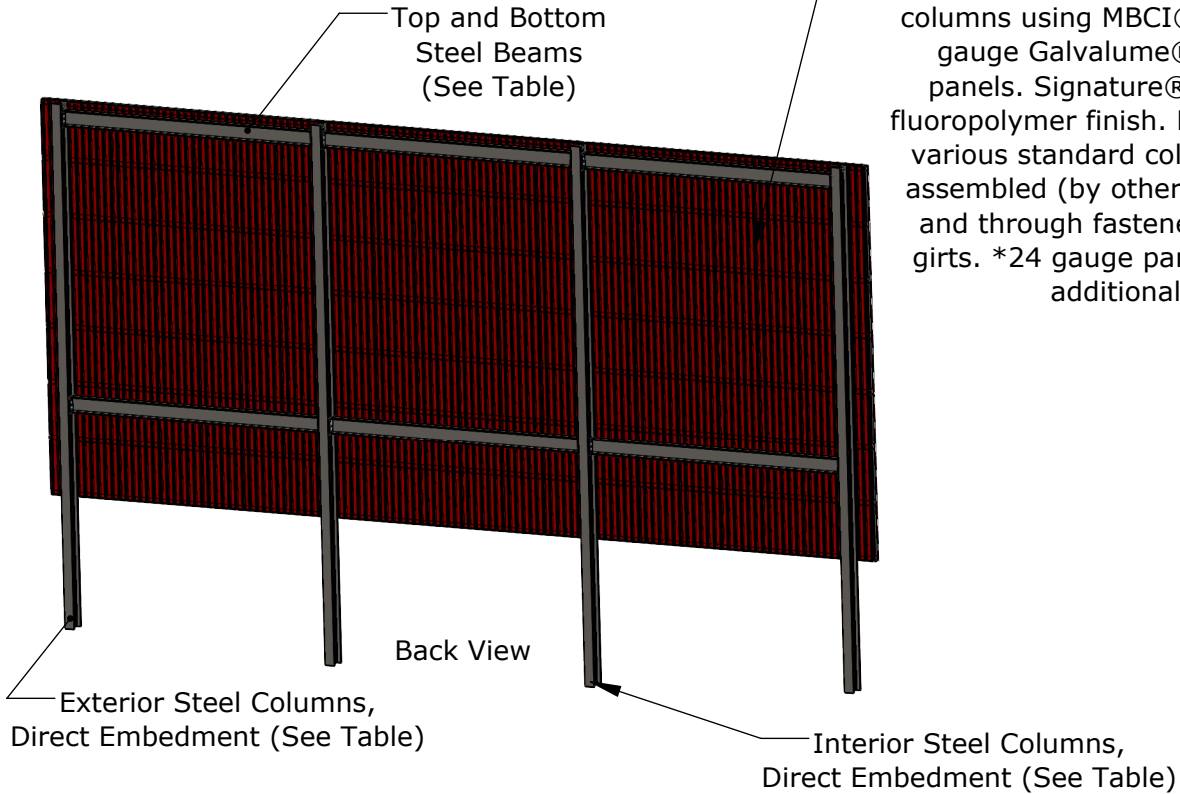

Harbor Blue



Colonial Red



Midnight Bronze



Classic Green



Hunter Green

Color output may not be exact as on this document due to variations in monitors and printers. Color approval must be based on specific color samples rather than their visual representation in this document.

PROPRIETARY AND CONFIDENTIAL

THE INFORMATION CONTAINED IN THIS DRAWING IS THE SOLE PROPERTY OF SPORTSFIELD SPECIALTIES INC. ANY REPRODUCTION IN PART OR AS A WHOLE WITHOUT THE WRITTEN PERMISSION OF SPORTSFIELD SPECIALTIES INC. IS PROHIBITED.

Solid Surface Batter's Eye with Ribbed Profile Wall Panels and Exposed Fasteners, Direct Embedment, Double Sided

Not To Scale

Sportsfield Specialties Inc 11142023

Standard Black Powder Coated Finish on Framing Components, Various Standard Colors Available

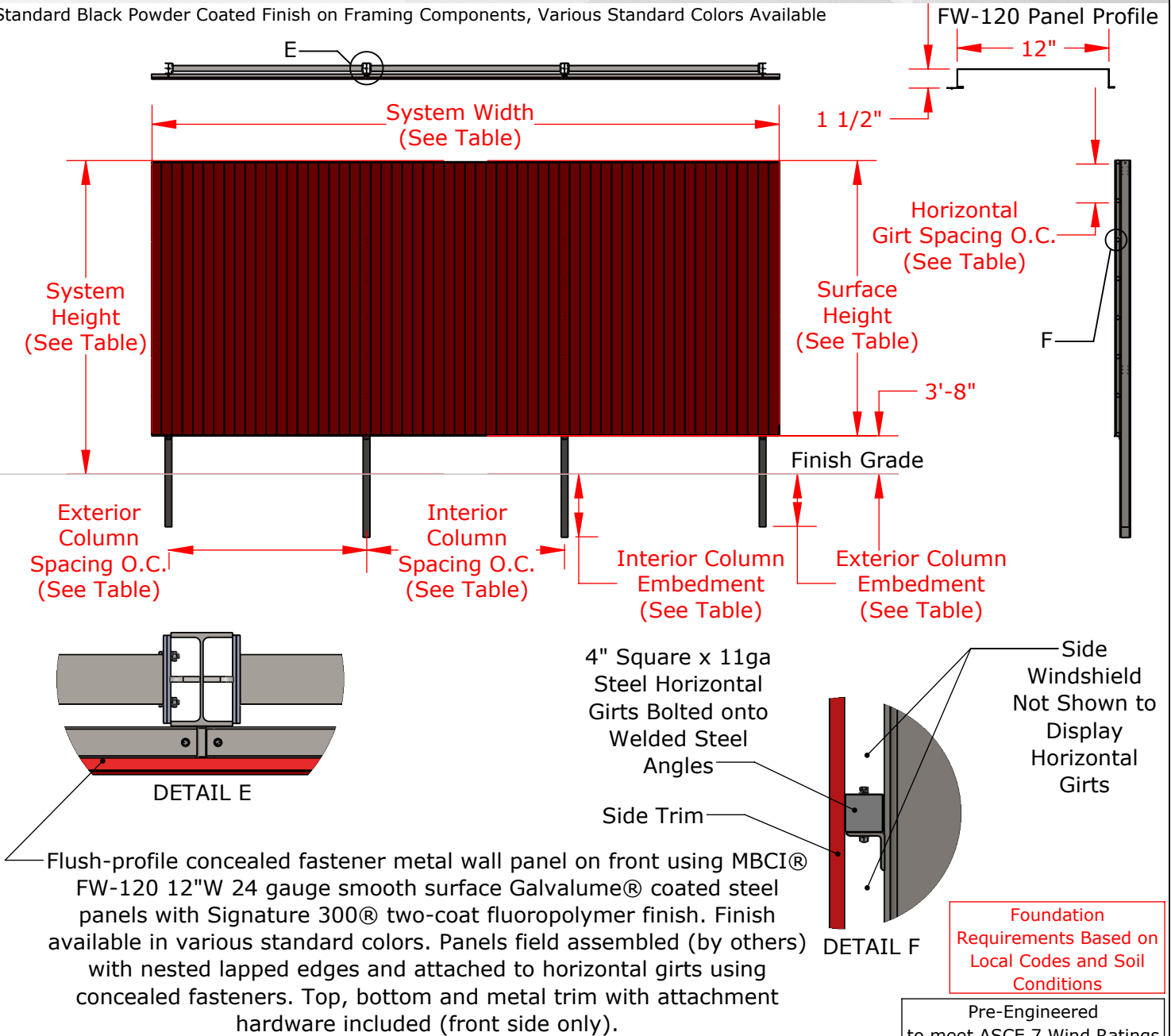

Part No.	System Height	System Width	Surface Height	# of Columns	Interior Column Spacing (O.C.)	Exterior Column Spacing (O.C.)	Interior Column Embedment	Exterior Column Embedment	Horizontal Girt Spacing (O.C.)
BESF2040S	20'-0"	40'-0"	16'-4"	3	18'-9 1/2"	18'-9 1/2"	4'-0"	4'-0"	5'-4"
BESF3060S	30'-0"	60'-0"	26'-4"	4	18'-11"	18'-11"	6'-0"	5'-0"	3'-8 5/8"
BESF3660S	36'-0"	60'-0"	32'-4"	4	19'-1"	19'-1"	8'-0"	6'-0"	4'
BESF4080S	40'-0"	80'-0"	36'-4"	5	19'-1 5/16"	19'-1 1/4"	8'-0"	8'-0"	4'

PROPRIETARY AND CONFIDENTIAL

THE INFORMATION CONTAINED IN THIS DRAWING IS THE SOLE PROPERTY OF SPORTSFIELD SPECIALTIES INC. ANY REPRODUCTION IN PART OR AS A WHOLE WITHOUT THE WRITTEN PERMISSION OF SPORTSFIELD SPECIALTIES INC. IS PROHIBITED.

**Solid Surface Batter's Eye with Flush Wall
Panels and Concealed Fasteners, Direct Embedment, Single Sided**

Not To Scale

Sportsfield Specialties Inc 11142023

Part No.	Exterior Column Size	Interior Column Size	Beam Size
BESF2040S	W8x24	W8X24	W8X13
BESF3060S	W12X45	W12X50	W12X26
BESF3660S	W14X61	W14X68	W12X26
BESF4080S	W16X67	W16X77	W12X26

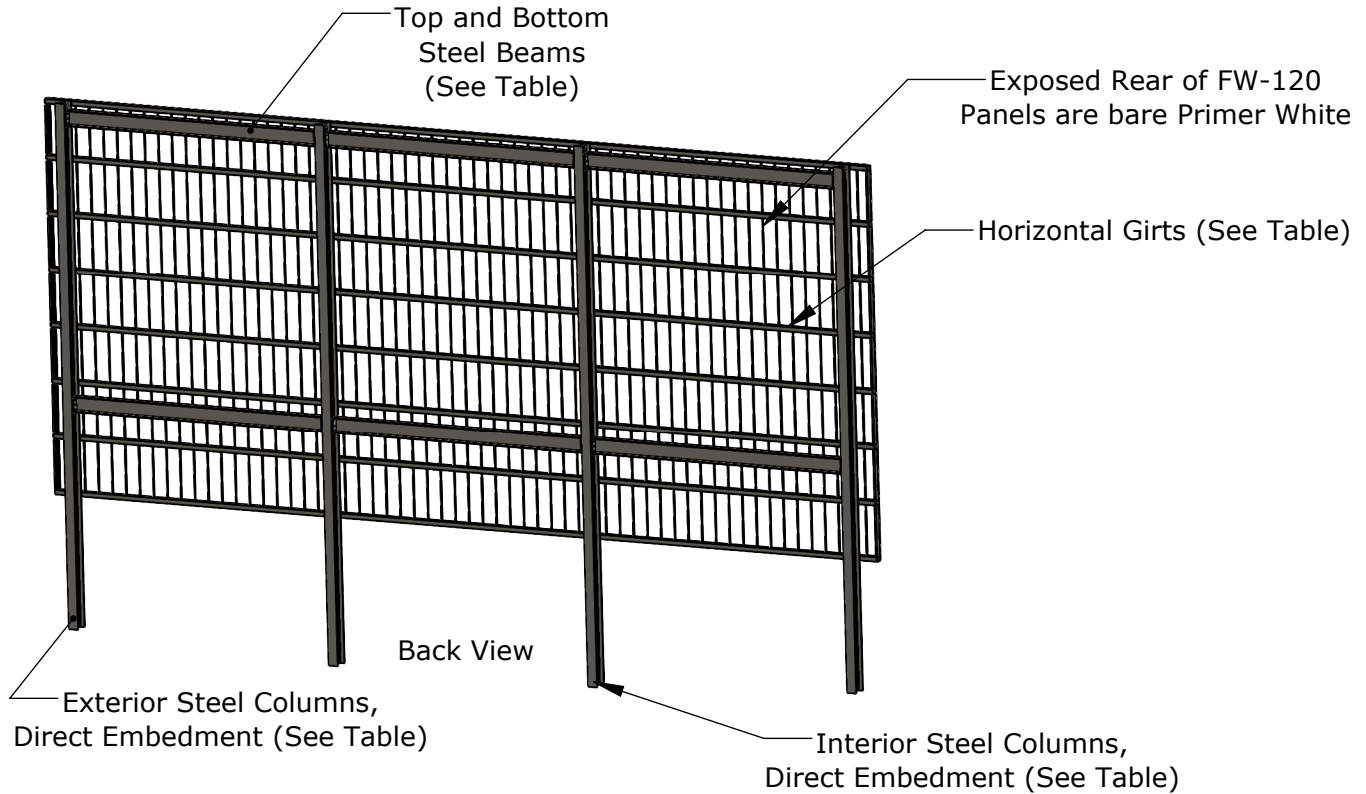

MBCI® Signature® 300 Standard Colors
Polyvinylidene Fluoride (PVDF)
Low Gloss



Harbor Blue



Colonial Red



Midnight Bronze



Classic Green



Hunter Green

Color output may not be exact as on this document due to variations in monitors and printers. Color approval must be based on specific color samples rather than their visual representation in this document.

PROPRIETARY AND CONFIDENTIAL

THE INFORMATION CONTAINED IN THIS DRAWING IS THE SOLE PROPERTY OF SPORTSFIELD SPECIALTIES INC. ANY REPRODUCTION IN PART OR AS A WHOLE WITHOUT THE WRITTEN PERMISSION OF SPORTSFIELD SPECIALTIES INC. IS PROHIBITED.

**Solid Surface Batter's Eye with Flush Wall
Panels and Concealed Fasteners, Direct Embedment, Single Sided**

Not To Scale

Sportsfield Specialties Inc 11142023

Standard Black Powder Coated Finish on Framing Components, Various Standard Colors Available

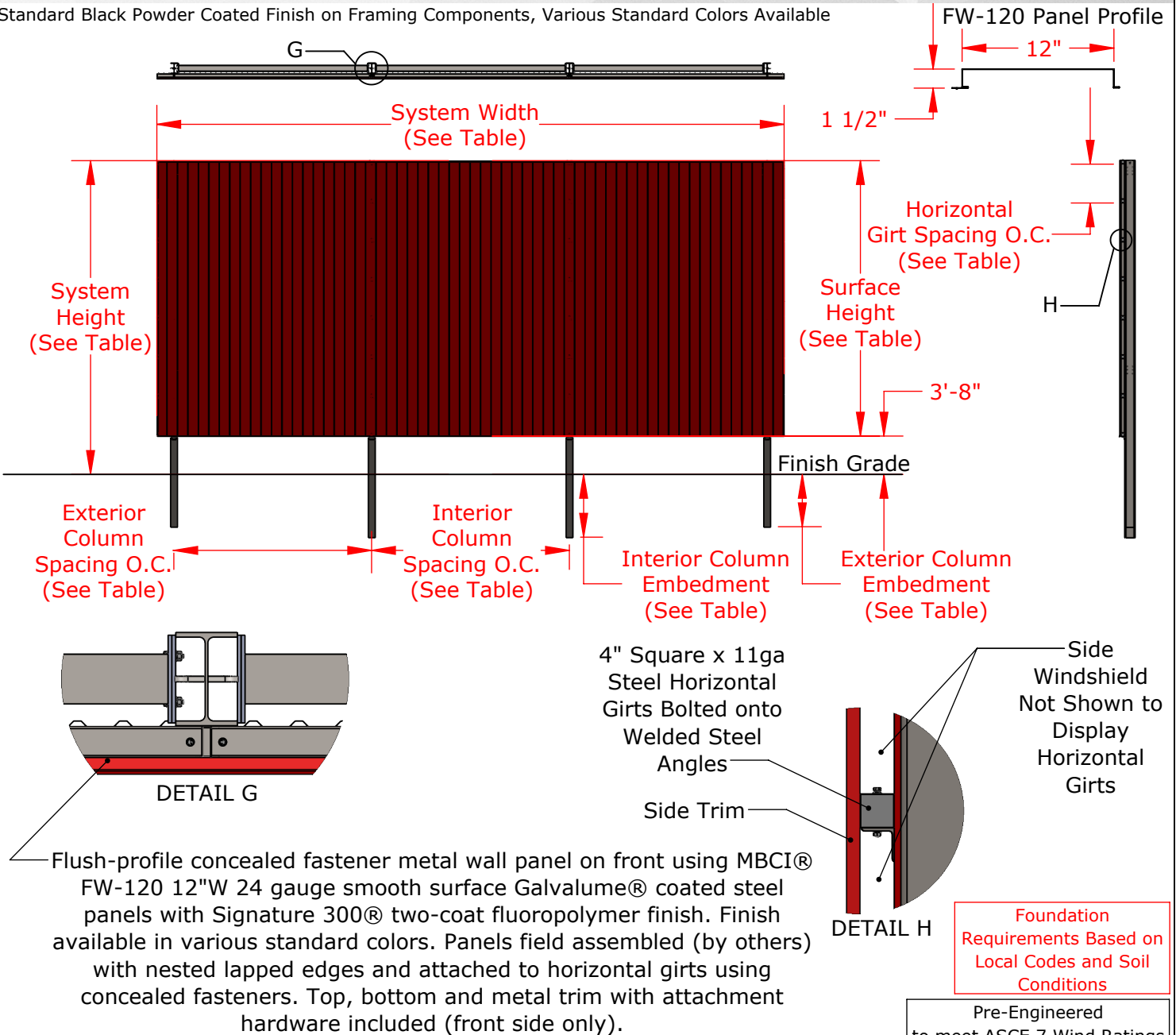

Part No.	System Height	System Width	Surface Height	# of Columns	Interior Column Spacing (O.C.)	Exterior Column Spacing (O.C.)	Interior Column Embedment	Exterior Column Embedment	Horizontal Girt Spacing (O.C.)
BESF2040	20'-0"	40'-0"	16'-4"	3	18'-9 1/2"	18'-9 1/2"	4'-0"	4'-0"	5'-4"
BESF3060	30'-0"	60'-0"	26'-4"	4	18'-11"	18'-11"	6'-0"	5'-0"	3'-8 5/8"
BESF3660	36'-0"	60'-0"	32'-4"	4	19'-1"	19'-1"	8'-0"	6'-0"	4'
BESF4080	40'-0"	80'-0"	36'-4"	5	19'-1 5/16"	19'-1 1/4"	8'-0"	8'-0"	4'

PROPRIETARY AND CONFIDENTIAL

THE INFORMATION CONTAINED IN THIS DRAWING IS THE SOLE PROPERTY OF SPORTSFIELD SPECIALTIES INC. ANY REPRODUCTION IN PART OR AS A WHOLE WITHOUT THE WRITTEN PERMISSION OF SPORTSFIELD SPECIALTIES INC. IS PROHIBITED.

Solid Surface Batter's Eye with Flush Wall Panels and Concealed Fasteners, Direct Embedment, Double Sided

Not To Scale

Sportsfield Specialties Inc 11142023

Part No.	Exterior Column Size	Interior Column Size	Beam Size
BESF2040	W8x24	W8X24	W8X13
BESF3060	W12X45	W12X50	W12X26
BESF3660	W14X61	W14X68	W12X26
BESF4080	W16X67	W16X77	W12X26

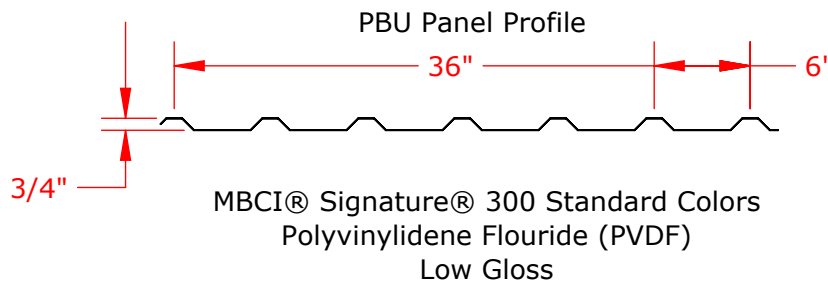
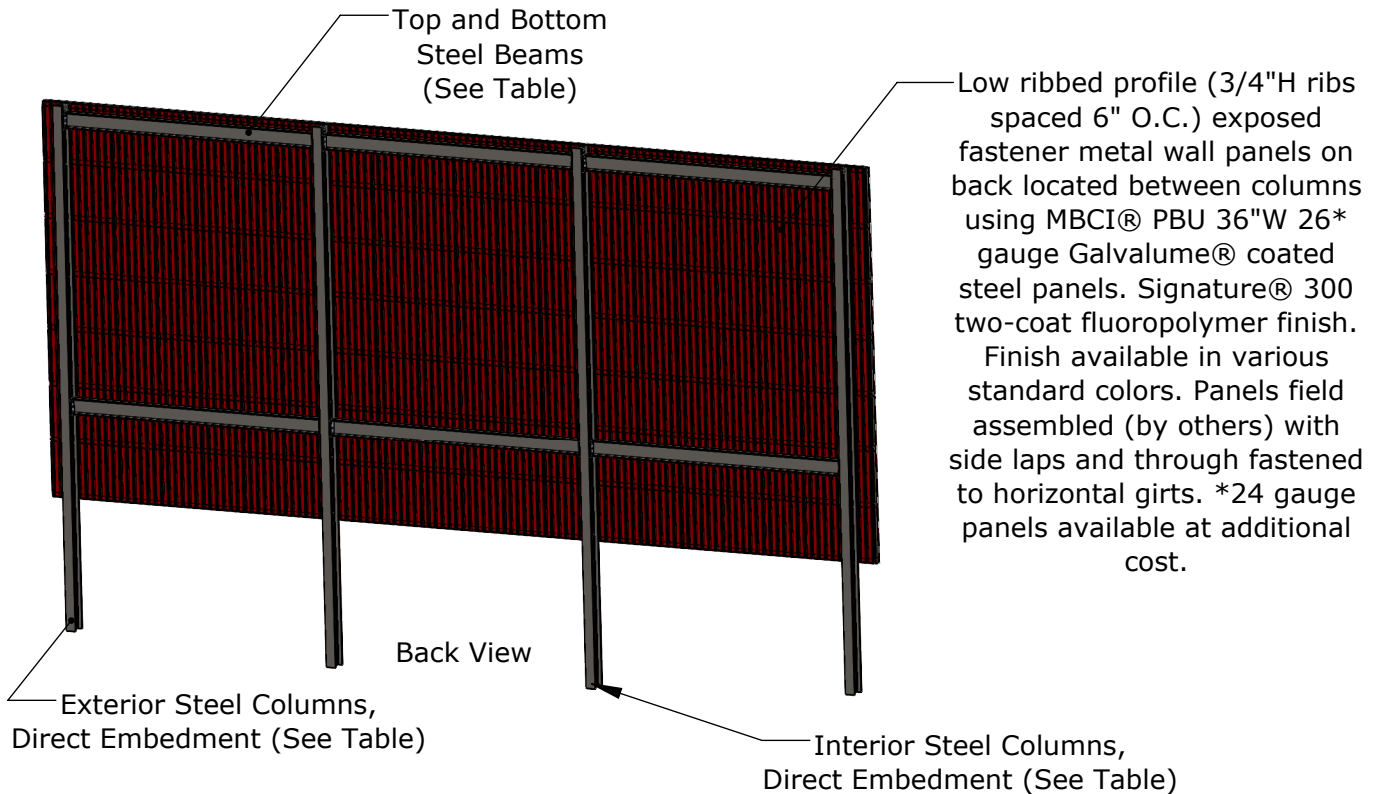

Harbor Blue



Colonial Red



Midnight Bronze



Classic Green



Hunter Green

Color output may not be exact as on this document due to variations in monitors and printers. Color approval must be based on specific color samples rather than their visual representation in this document.

PROPRIETARY AND CONFIDENTIAL

THE INFORMATION CONTAINED IN THIS DRAWING IS THE SOLE PROPERTY OF SPORTSFIELD SPECIALTIES INC. ANY REPRODUCTION IN PART OR AS A WHOLE WITHOUT THE WRITTEN PERMISSION OF SPORTSFIELD SPECIALTIES INC. IS PROHIBITED.

Solid Surface Batter's Eye with Flush Wall Panels and Concealed Fasteners, Direct Embedment, Double Sided

Not To Scale

Sportsfield Specialties Inc 11142023

Standard Black Powder Coated Finish on Framing Components

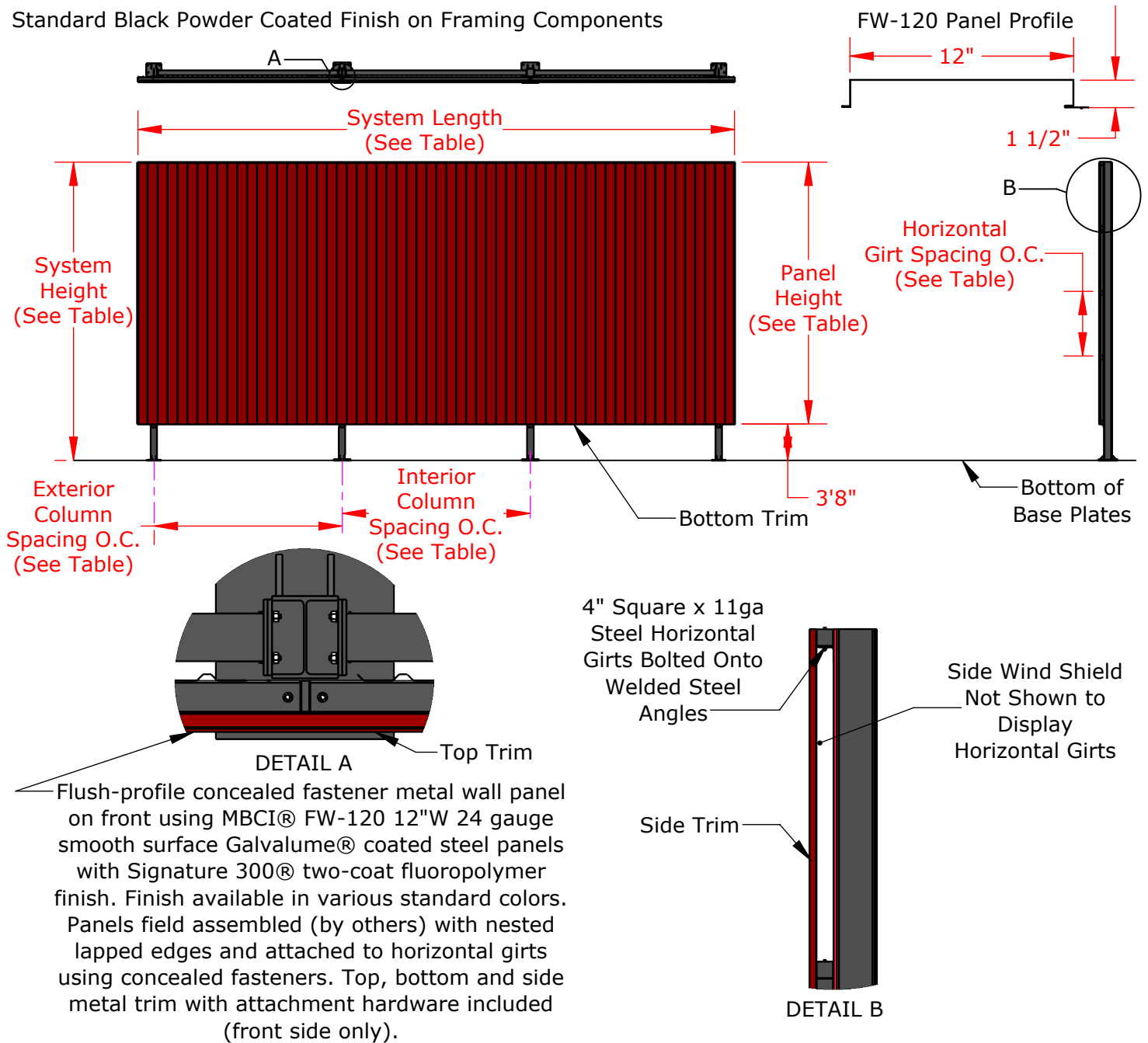

Part No.	System Height	System Length	Panel Height	# of Columns	Interior Column Spacing (O.C.)	Exterior Column Spacing (O.C.)	Horizontal Girt Spacing (O.C.)
BESF2040PL	20'-0"	40'-0"	16'-4"	3	18'-9"	18'-9"	5'-4"
BESF3060PL	30'-0"	60'-0"	26'-4"	4	18'-11"	18'-11"	6'-6"
BESF4080PL	40'-0"	80'-0"	36'-4"	5	19'-1"	19'-0"	6'-0"

Foundation Requirements
Based on Local Codes and
Soil Conditions

Professionally Pre-Engineered to meet
ASCE 7 Wind Ratings up to 105 mph
Exposure B

PROPRIETARY AND CONFIDENTIAL

THE INFORMATION CONTAINED IN THIS DRAWING IS THE SOLE PROPERTY OF SPORTSFIELD SPECIALTIES INC. ANY REPRODUCTION IN PART OR AS A WHOLE WITHOUT THE WRITTEN PERMISSION OF SPORTSFIELD SPECIALTIES INC. IS PROHIBITED.

Solid Surface Batter's Eye with Flush Profile Wall Panels and Concealed Fasteners, Plate Mount

Not To Scale

Sportsfield Specialties Inc. 04062021

Part No.	Interior Column Size	Interior Column Base Plate	Exterior Column Size	Exterior Column Base Plate	Top Beam Size
BESF2040PL	W8X24	1-3/8" X 18" X 18"	W8X21	1" X 16" X 16"	W8X13
BESF3060PL	W10X39	2" X 21-1/2" X 24-1/2"	W10X33	1-1/2" X 18-1/2" X 22-1/2"	W10X22
BESF4080PL	W12X58	2-1/4" X 28" X 32"	W12X45	1-1/2" X 23" X 29"	W12X26

Top Steel Beams
(See Table)

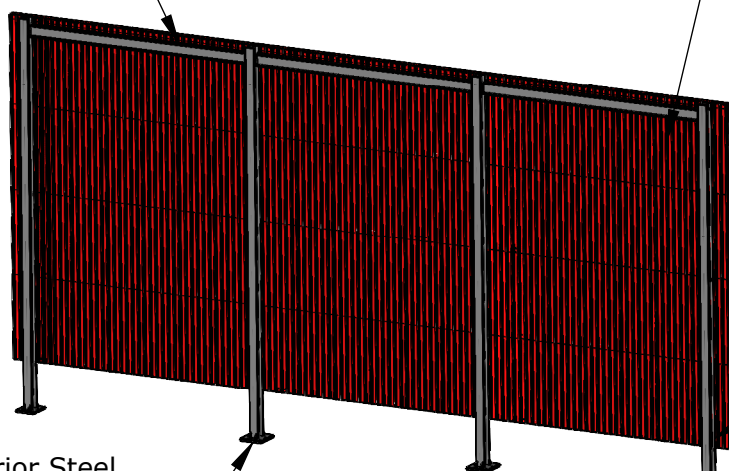

Low ribbed profile (3/4"H ribs spaced 6" O.C.) exposed fastener metal wall panel on back located between columns using MBCI® PBU 36"W 26* gauge Galvalume® coated steel panels. Signature® 300 two-coat fluoropolymer finish. Finish available in various standard colors. Panels field assembled (by others) with side laps and through-fastened to horizontal girts.
*24 gauge panels available at additional cost

Interior Steel Columns with Base Plates
(See Table)

Back View

Exterior Steel Columns with Base Plates
(See Table)

Provided anchor rods, plate washers, anchor templates and related hardware not shown for clarity. Plate washers require field welding (by others) to allow for oversized holes in base plates. Refer to Construction Details for additional information.

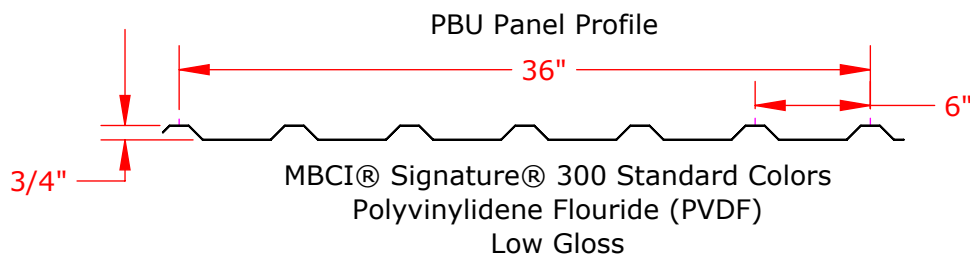

Harbor Blue



Colonial Red



Midnight Bronze



Classic Green



Hunter Green

Color output may not be exact as on this document due to variations in monitors and printers. Color approval must be based on specific color samples rather than their visual representation in this document.

PROPRIETARY AND CONFIDENTIAL

THE INFORMATION CONTAINED IN THIS DRAWING IS THE SOLE PROPERTY OF SPORTSFIELD SPECIALTIES INC. ANY REPRODUCTION IN PART OR AS A WHOLE WITHOUT THE WRITTEN PERMISSION OF SPORTSFIELD SPECIALTIES INC. IS PROHIBITED.

Solid Surface Batter's Eye with Flush Profile Wall Panels and Concealed Fasteners, Plate Mount

Not To Scale

Sportsfield Specialties Inc 04062021

Standard Black Powder Coated Finish on Framing Components

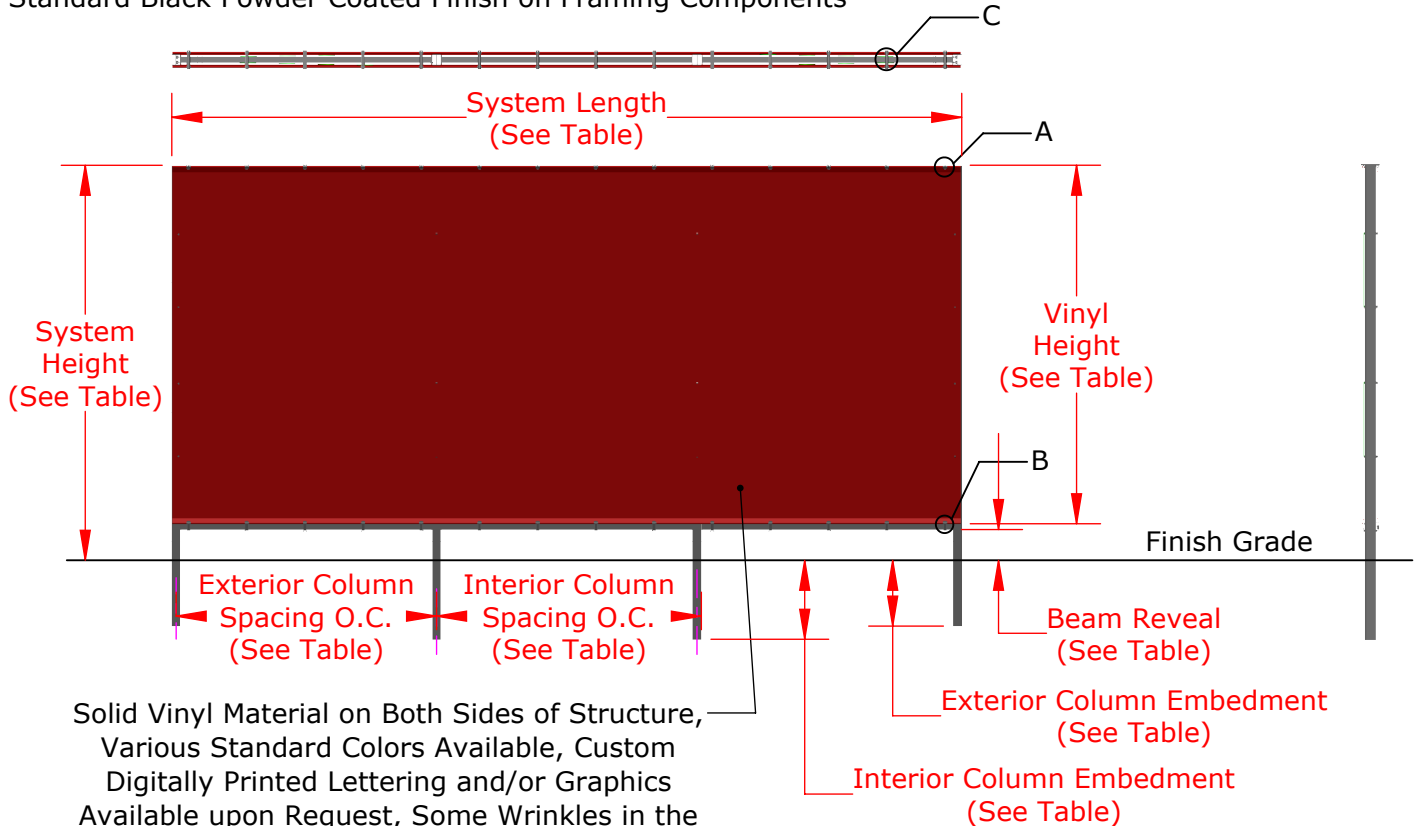

Solid Vinyl Material on Both Sides of Structure, Various Standard Colors Available, Custom Digitally Printed Lettering and/or Graphics Available upon Request, Some Wrinkles in the Solid Vinyl are Characteristic of the Material and are to be Expected

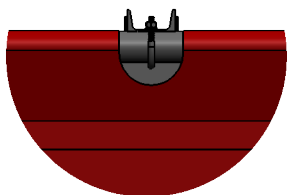

DETAIL A

Top Tubes Inserted through Solid Vinyl Pockets and Hung by U-Bolts

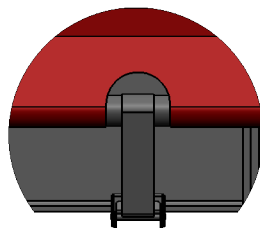

DETAIL B

Bottom Tubes Inserted through Solid Vinyl Pockets and Tensioned Downwards using 2"W Ratchet Straps

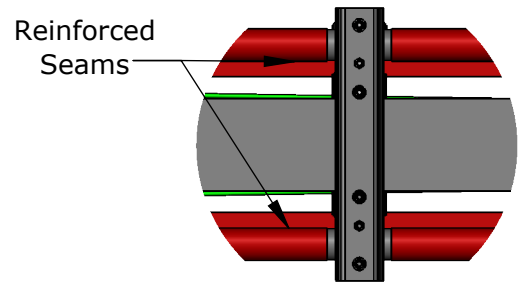

DETAIL C

Solid Vinyl Mounting, Typical on Both Sides of Structure

Part No.	System Height	System Length	Vinyl Height	# of Columns	Interior Column Spacing (O.C.)	Exterior Column Spacing (O.C.)	Interior Column Embedment	Exterior Column Embedment	Beam Reveal
BE2040	20'-0"	40'-0"	15'-10 3/4"	3	19'-9 3/8"	19'-9 3/8"	4'-0"	4'-0"	3'-8"
BE3060	30'-0"	60'-0"	27'-2 3/4"	4	19'-9 3/8"	19'-9 3/8"	6'-0"	5'-0"	2'-4"
BE4080	40'-0"	80'-0"	37'-1 1/4"	5	19'-10 1/2"	19'-9 1/2"	8'-0"	5'-0"	2'-4"

PROPRIETARY AND CONFIDENTIAL

THE INFORMATION CONTAINED IN THIS DRAWING IS THE SOLE PROPERTY OF SPORTSFIELD SPECIALTIES INC. ANY REPRODUCTION IN PART OR AS A WHOLE WITHOUT THE WRITTEN PERMISSION OF SPORTSFIELD SPECIALTIES INC. IS PROHIBITED.

**Solid Vinyl Batter's Eye,
Direct Embedment**

Not To Scale

Sportsfield Specialties Inc 04252022

Part No.	Interior Column Size	Exterior Column Size	Top and Bottom Beam Size
BE2040	W8X24	W8X21	W8X13
BE3060	W10X39	W10X33	W10X22
BE4080	W12X58	W12X45	W12X26

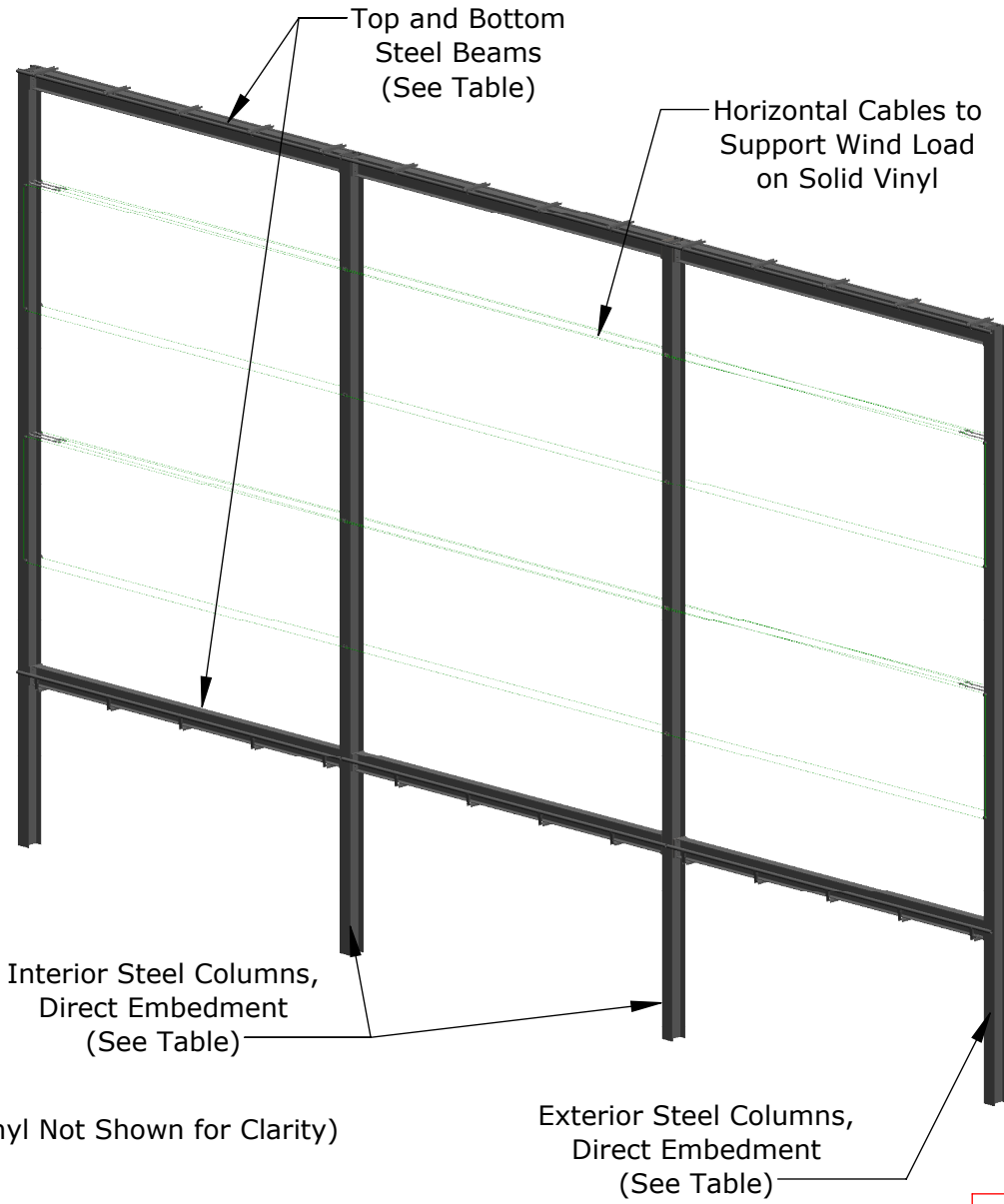

Professionally Pre-Engineered to meet ASCE 7 Wind Ratings up to 105 mph Exposure B

Foundation Requirements Based on Local Codes and Soil Conditions

PROPRIETARY AND CONFIDENTIAL

THE INFORMATION CONTAINED IN THIS DRAWING IS THE SOLE PROPERTY OF SPORTSFIELD SPECIALTIES INC. ANY REPRODUCTION IN PART OR AS A WHOLE WITHOUT THE WRITTEN PERMISSION OF SPORTSFIELD SPECIALTIES INC. IS PROHIBITED.

Solid Vinyl Batter's Eye, Direct Embedment

Not To Scale

Sportsfield Specialties Inc 04252022

Standard Black Powder Coated Finish on Framing Components

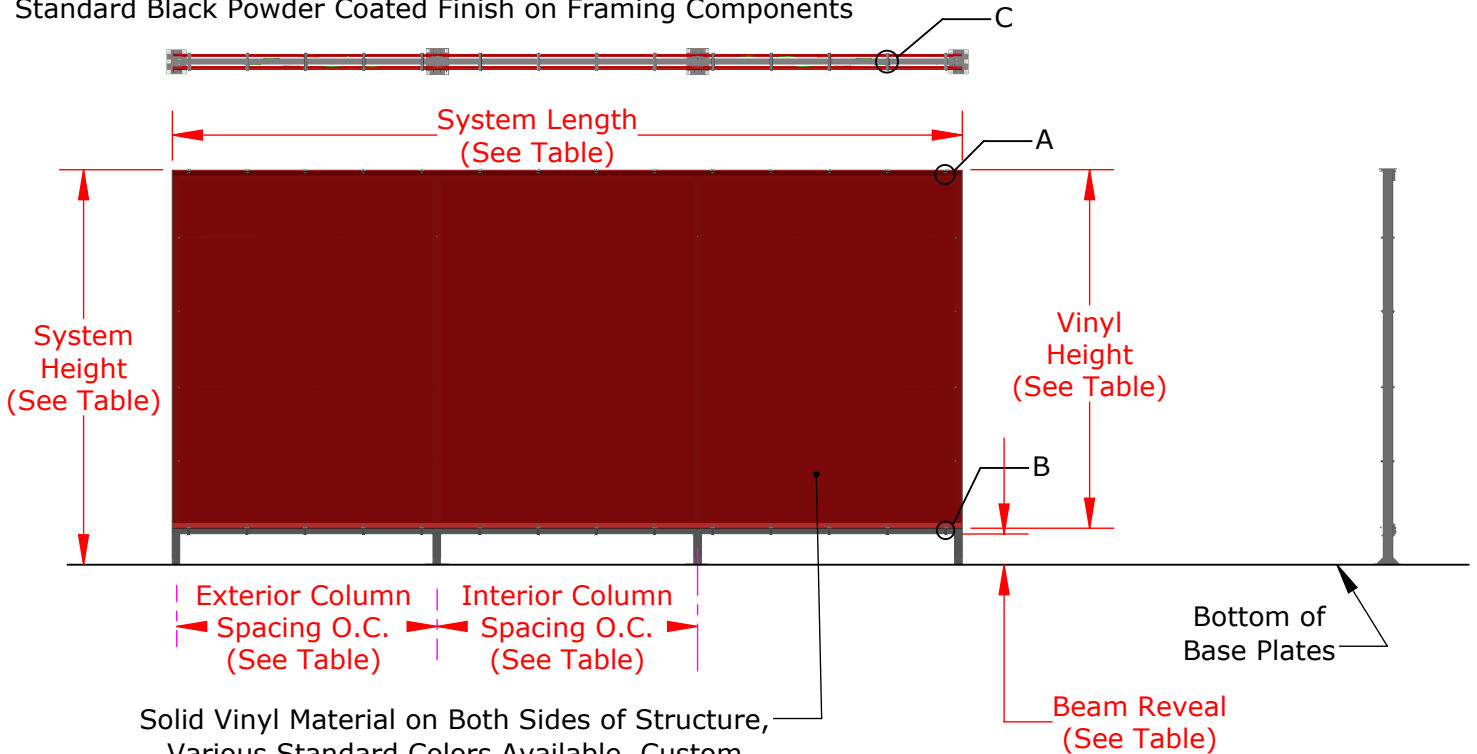

Solid Vinyl Material on Both Sides of Structure, Various Standard Colors Available, Custom Digitally Printed Lettering and/or Graphics Available Upon Request, Some Wrinkles in the Solid Vinyl are Characteristic of the Material and are to be Expected

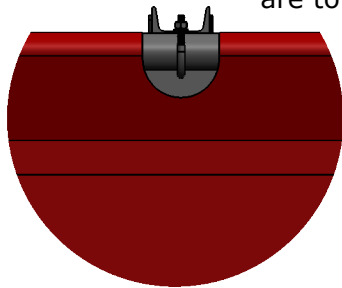

DETAIL A
Top Tubes Inserted through Solid Vinyl Pockets and Hung by U-Bolts

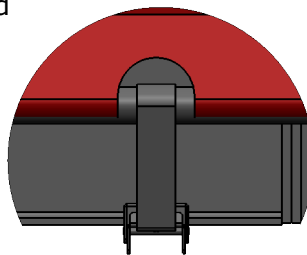

DETAIL B
Bottom Tubes Inserted through Solid Vinyl Pockets and Tensioned Downwards using 2" W Ratchet Straps

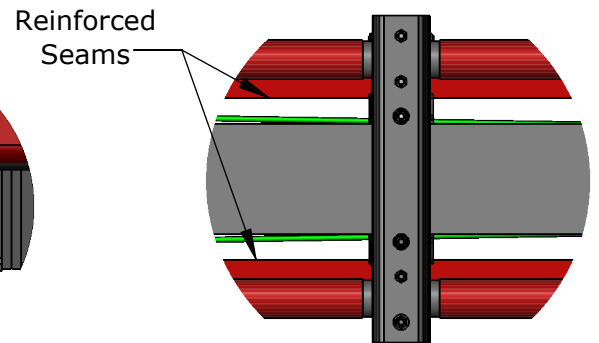

DETAIL C
Solid Vinyl Mounting, Typical on Both Sides of Structure

Part No.	System Height	System Length	Vinyl Height	# of Columns	Interior Column Spacing (O.C.)	Exterior Column Spacing (O.C.)	Beam Reveal
BE2040PL	20'-0"	40'-0"	15'-10 3/4"	3	19'-9 3/8"	19'-9 3/8"	3'-8"
BE3060PL	30'-0"	60'-0"	27'-2 3/4"	4	19'-9 3/8"	19'-9 3/8"	2'-4"
BE4080PL	40'-0"	80'-0"	37'-1 1/4"	5	19'-10 1/2"	19'-9 1/2"	2'-4"

PROPRIETARY AND CONFIDENTIAL

THE INFORMATION CONTAINED IN THIS DRAWING IS THE SOLE PROPERTY OF SPORTSFIELD SPECIALTIES INC. ANY REPRODUCTION IN PART OR AS A WHOLE WITHOUT THE WRITTEN PERMISSION OF SPORTSFIELD SPECIALTIES INC. IS PROHIBITED.

Solid Vinyl Batter's Eye, Plate Mount

Not To Scale

Sportsfield Specialties Inc 04252022

Part No.	Interior Column Size	Interior Column Base Plate	Exterior Column Size	Exterior Column Base Plate	Top Beam Size
BE2040PL	W8X24	1-3/8" X 18" X 18"	W8X21	1" X 16" X 16"	W8X13
BE3060PL	W10X39	2" X 21-1/2" X 24-1/2"	W10X33	1-1/2" X 18-1/2" X 22-1/2"	W10X22
BE4080PL	W12X58	2-1/4" X 28" X 32"	W12X45	1-1/2" X 23" X 29"	W12X26

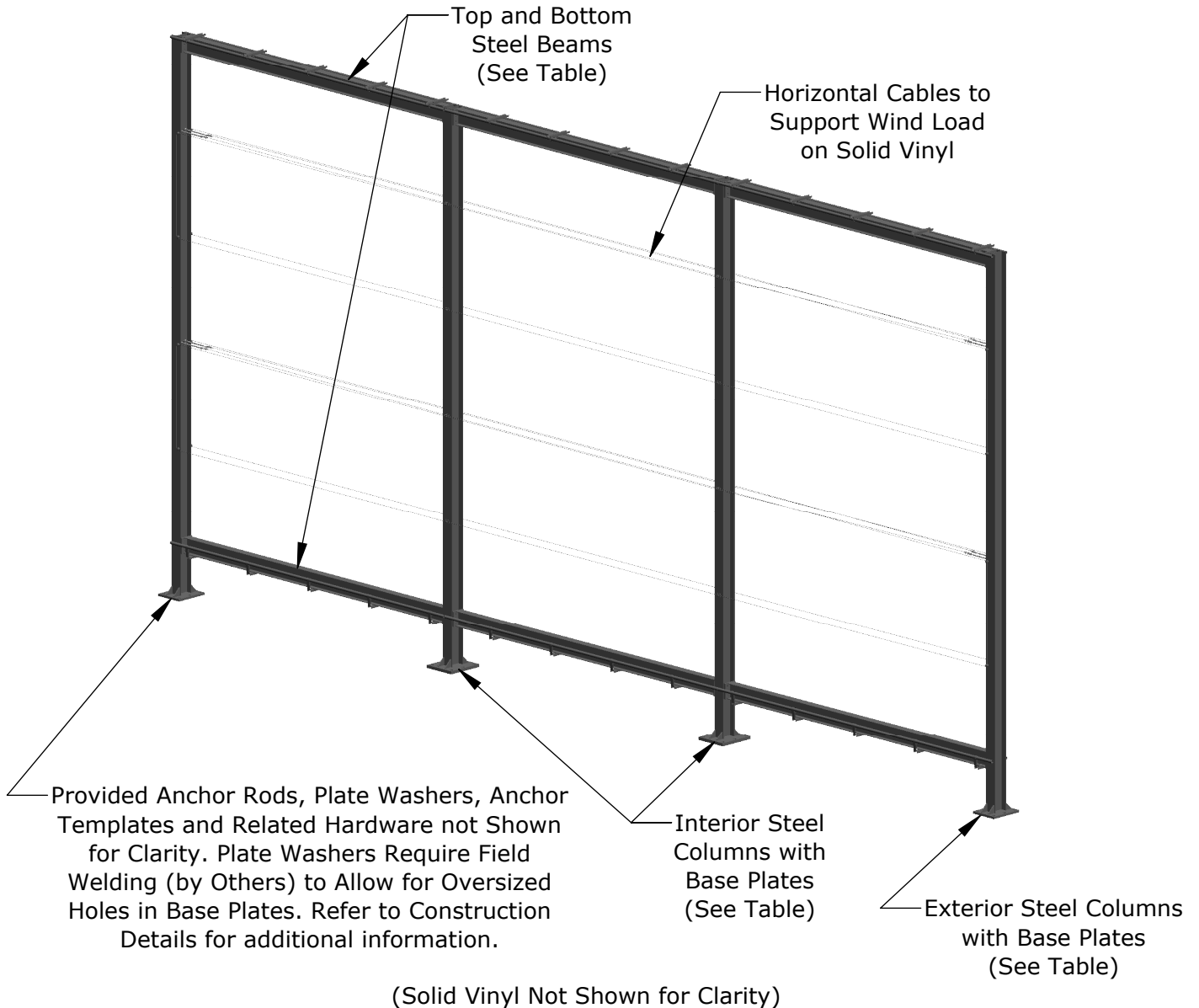

Professionally Pre-Engineered to meet ASCE 7 Wind Ratings up to 105 mph Exposure B

Foundation Requirements Based on Local Codes and Soil Conditions

PROPRIETARY AND CONFIDENTIAL

THE INFORMATION CONTAINED IN THIS DRAWING IS THE SOLE PROPERTY OF SPORTSFIELD SPECIALTIES INC. ANY REPRODUCTION IN PART OR AS A WHOLE WITHOUT THE WRITTEN PERMISSION OF SPORTSFIELD SPECIALTIES INC. IS PROHIBITED.

Solid Vinyl Batter's Eye, Plate Mount

Not To Scale

Sportsfield Specialties Inc 04252022

Standard Black Powder Coated Finish on Framing Components

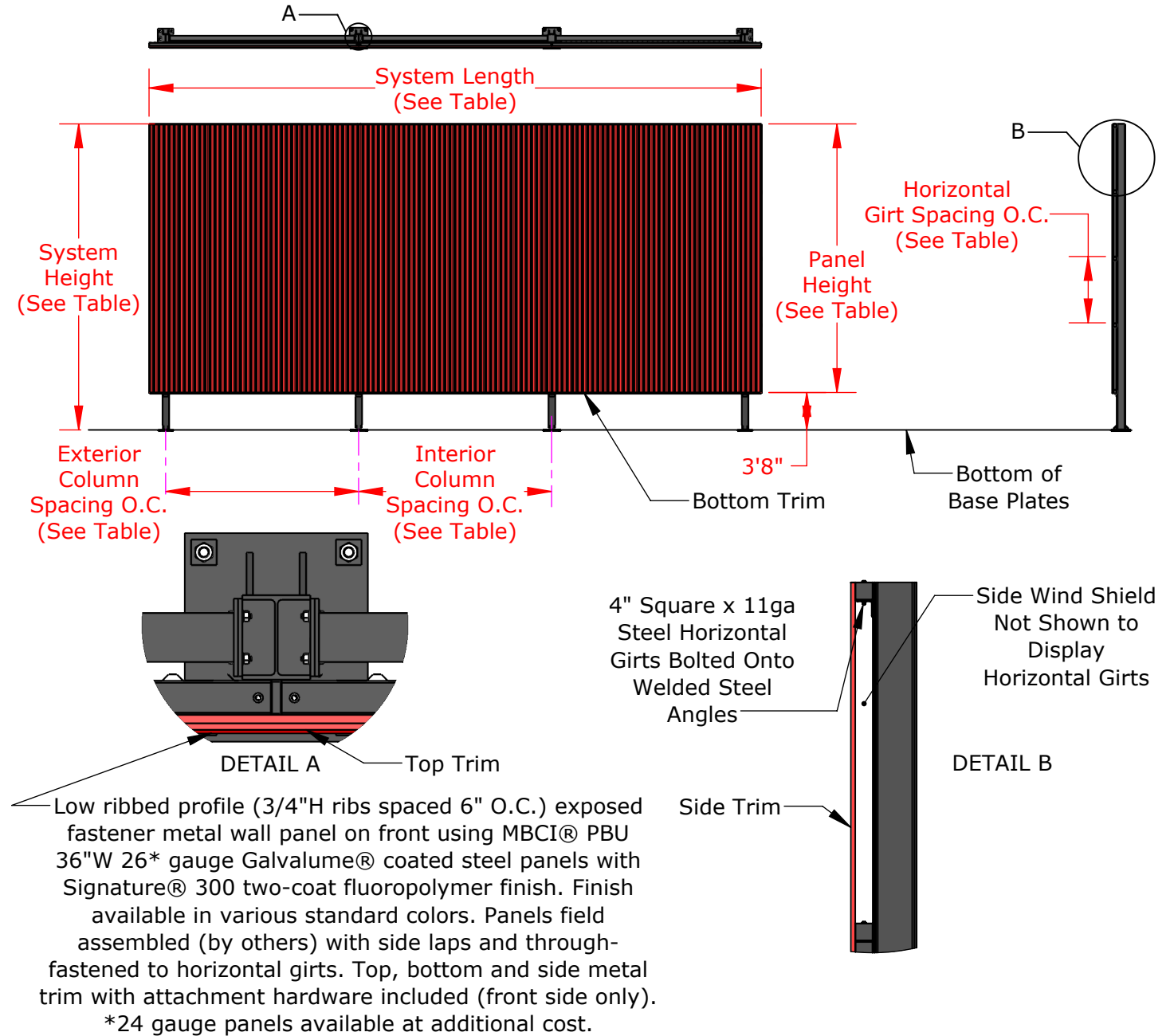

Part No.	System Height	System Length	Panel Height	# of Columns	Interior Column Spacing (O.C.)	Exterior Column Spacing (O.C.)	Horizontal Girt Spacing (O.C.)
BESR2040PL	20'-0"	40'-0"	16'-4"	3	18'-9"	18'-9"	5'-4"
BESR3060PL	30'-0"	60'-0"	26'-4"	4	18'-11"	18'-11"	6'-6"
BESR4080PL	40'-0"	80'-0"	36'-4"	5	19'-1"	19'-0"	6'-0"

Foundation Requirements
Based on Local Codes and
Soil Conditions

Professionally Pre-Engineered to meet
ASCE 7 Wind Ratings up to 105 mph
Exposure B

PROPRIETARY AND CONFIDENTIAL

THE INFORMATION CONTAINED IN THIS DRAWING IS THE SOLE PROPERTY OF SPORTSFIELD SPECIALTIES INC. ANY REPRODUCTION IN PART OR AS A WHOLE WITHOUT THE WRITTEN PERMISSION OF SPORTSFIELD SPECIALTIES INC. IS PROHIBITED.

Solid Surface Batter's Eye with Ribbed Profile Wall Panels and Exposed Fasteners, Plate Mount

Not To Scale

Sportsfield Specialties Inc. 04062021

Part No.	Interior Column Size	Interior Column Base Plate	Exterior Column Size	Exterior Column Base Plate	Top Beam Size
BESR2040PL	W8X24	1-3/8" X 18" X 18"	W8X21	1" X 16" X 16"	W8X13
BESR3060PL	W10X39	2" X 21-1/2" X 24-1/2"	W10X33	1-1/2" X 18-1/2" X 22-1/2"	W10X22
BESR4080PL	W12X58	2-1/4" X 28" X 32"	W12X45	1-1/2" X 23" X 29"	W12X26

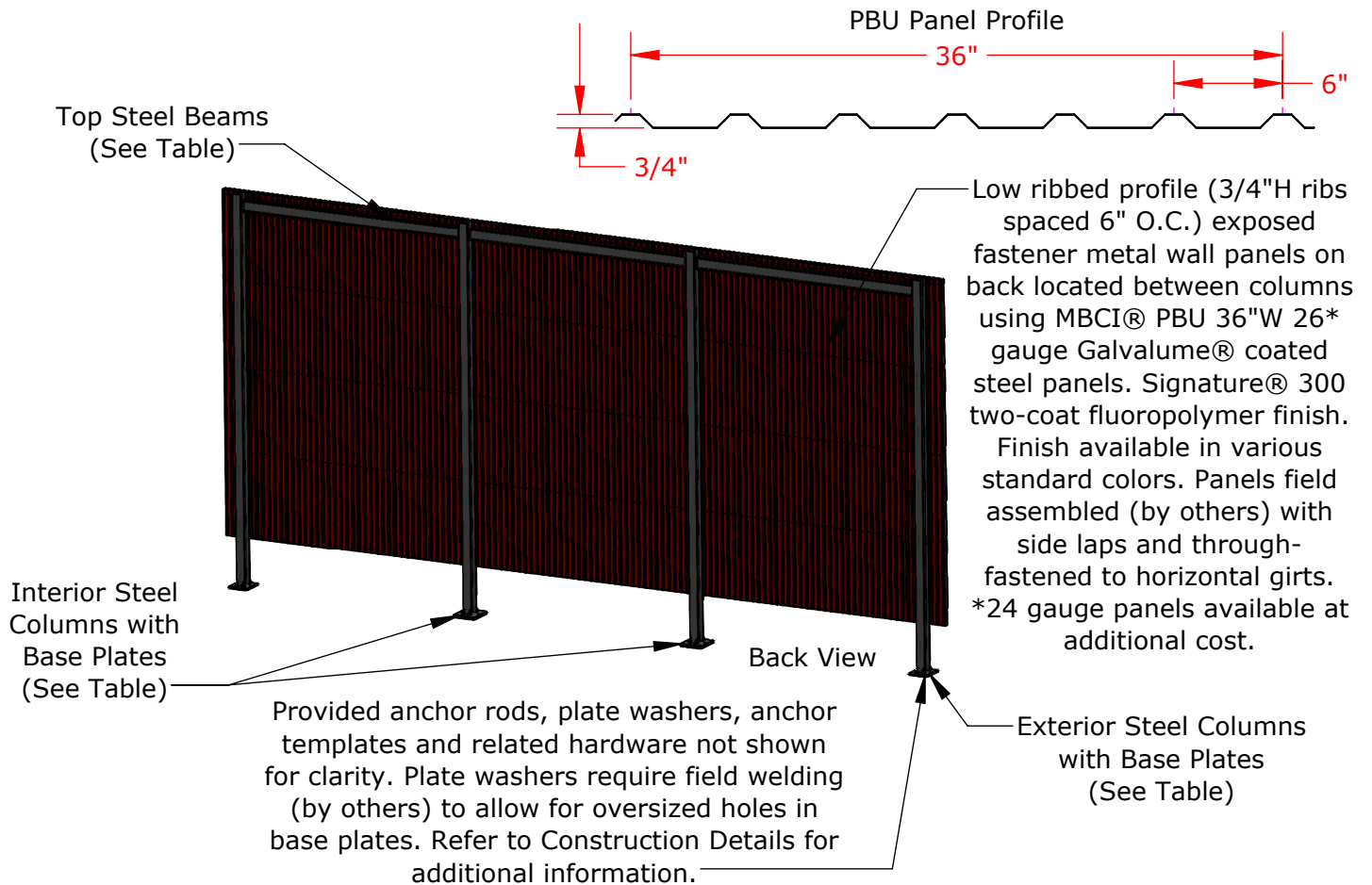

MBCI® Signature® 300 Standard Colors
Polyvinylidene Fluoride (PVDF)
Low Gloss



Harbor Blue



Colonial Red



Midnight Bronze



Classic Green



Hunter Green

Color output may not be exact as on this document due to variations in monitors and printers. Color approval must be based on specific color samples rather than their visual representation in this document.

PROPRIETARY AND CONFIDENTIAL

THE INFORMATION CONTAINED IN THIS DRAWING IS THE SOLE PROPERTY OF SPORTSFIELD SPECIALTIES INC. ANY REPRODUCTION IN PART OR AS A WHOLE WITHOUT THE WRITTEN PERMISSION OF SPORTSFIELD SPECIALTIES INC. IS PROHIBITED.

Solid Surface Batter's Eye with Ribbed Profile Wall Panels and Exposed Fasteners, Plate Mount

Not To Scale

Sportsfield Specialties Inc 04062021